

Name _____

Date _____

Period _____

Engineering Technology Department

Boxes, Fittings and Covers

Electrical box - a metallic or nonmetallic container used to mount devices, conduit, and cables; protect people from electrical shock; keep exposed conductors away from combustible building materials and act as a pull point.

Box Shapes – Square, Octagonal, Rectangular & Round

Materials - Metallic or Non-Metallic



Ceiling box - An electrical box intended for supporting ceiling fixtures.



Wall box - an electrical box for housing a switch or a receptacle

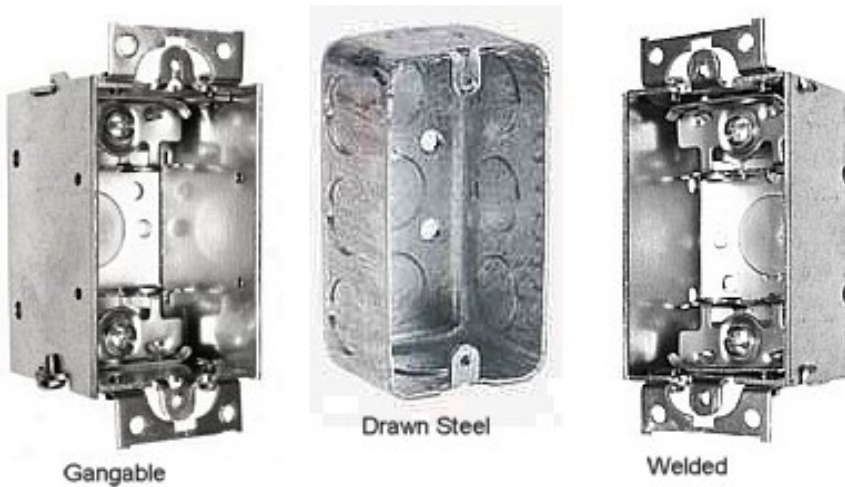

Types of Metal Switchboxes (new work)

Junction box - An electrical box that is installed wherever conductor splices or pulls must be made in a conduit run that is not appropriate for a switch, receptacle, or fixture.



Handy box - A seamless electrical box that has rounded corners and is designed to be surface mounted







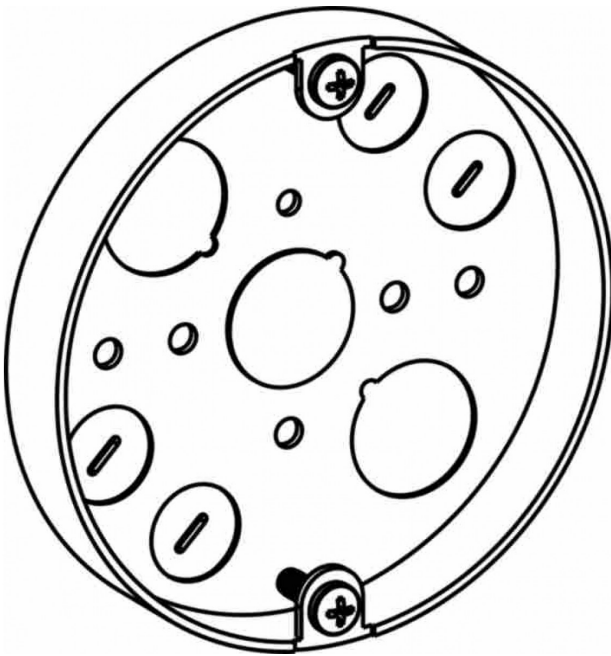

Knockout - A weakend area designed to be removed on an electrical box, allowing wires to be brought into the box.



Pryout - A knockout removed by inserting the blade of a screwdriver into the pryout's slot

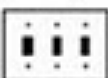

Ganging Boxes - A method of joining small boxes to create one large box that can accommodate multiple devices.

		1-Gang	4.50" tall, 2.75" wide
		2-Gang	4.50" tall, 4.56" wide
		3-Gang	4.50" tall, 6.37" wide
		4-Gang	4.50" tall, 8.18" wide
		5-Gang	4.50" tall, 9.99" wide
		6-Gang	4.50" tall, 11.80" wide
Standard Size			

Fittings - Parts of a wiring system designed to interconnect conduit, conductors, or boxes.

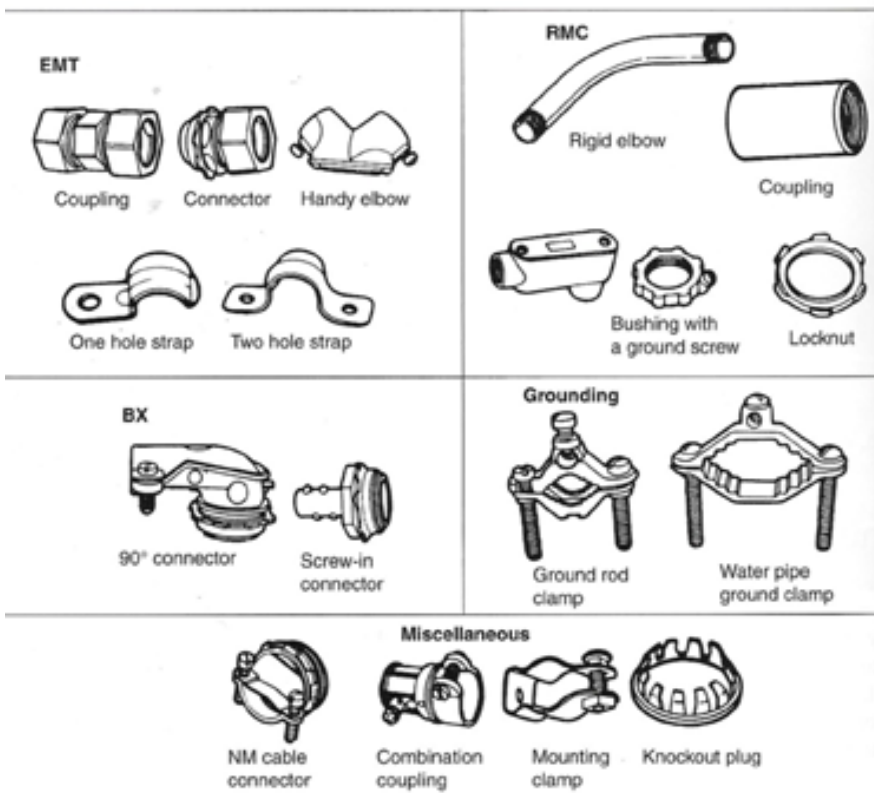



Connectors - Fittings that secure conduit or the outer covering of armored cable to an electrical box

Clamps - fittings that secure nonmetallic cable to an electrical box.

Ground Clip - a spring device that is hooked over the edge of a metallic box and holds a grounding wire so that the wire makes electrical contact with the box

Extension Rings - Boxes without a bottom that are used to provide additional space or bring an existing box flush to a wall or ceiling surface.



Box cover - A flat metallic or nonmetallic plate that is placed over a mounted switch or outlet, and is large enough to cover the wiring and exposed terminals that are in the box also called a faceplate.

