

Name _____

Date _____

Period _____

Engineering Technology Department

Boxes, Fittings and Covers

Electrical box - a metallic or nonmetallic container used to mount devices, conduit, and cables; protect people from electrical shock; keep exposed conductors away from combustible building materials and act as a pull point.

Box Shapes - _____

Materials - _____



_____ - An electrical box intended for supporting ceiling fixtures.



_____ - an electrical box for housing a switch or a receptacle

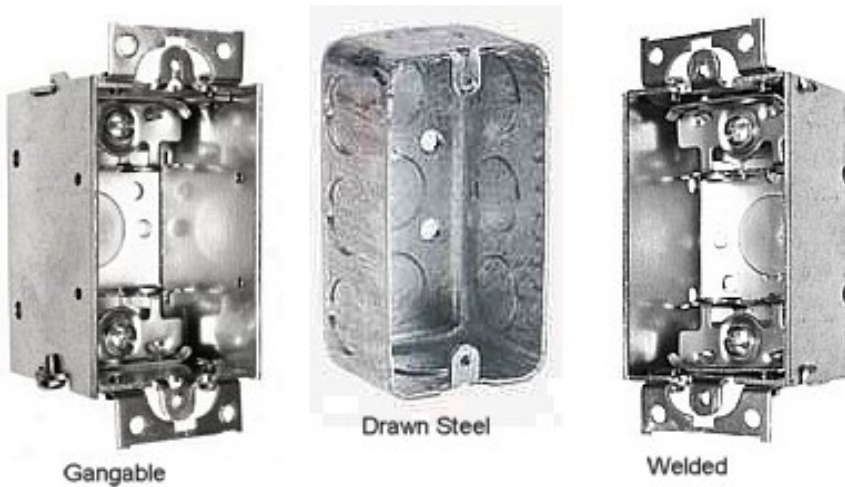

Types of Metal Switchboxes (new work)

_____ - An electrical box that is installed wherever conductor splices or pulls must be made in a conduit run that is not appropriate for a switch, receptacle, or fixture.



_____ - A seamless electrical box that has rounded corners and is designed to be surface mounted



_____ - A weakend area designed to be removed on an electrical box, allowing wires to be brought into the box.



_____ - A knockout removed by inserting the blade of a screwdriver into the pryout's slot

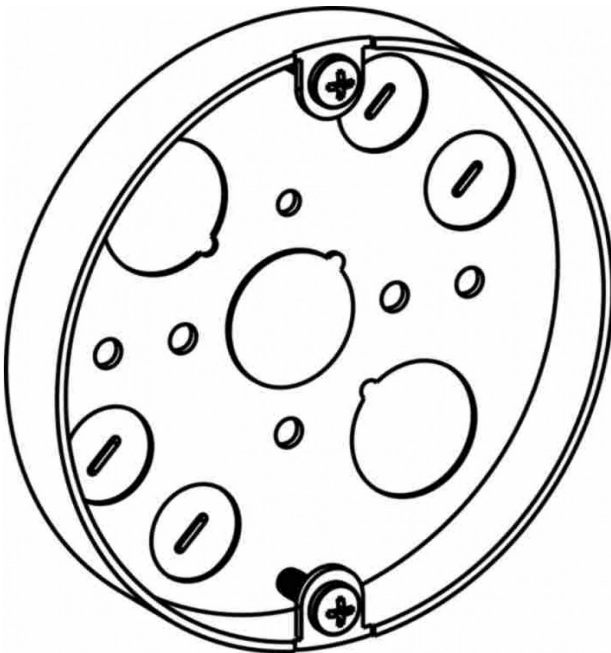

_____ - A method of joining small boxes to create one large box that can accommodate multiple devices.

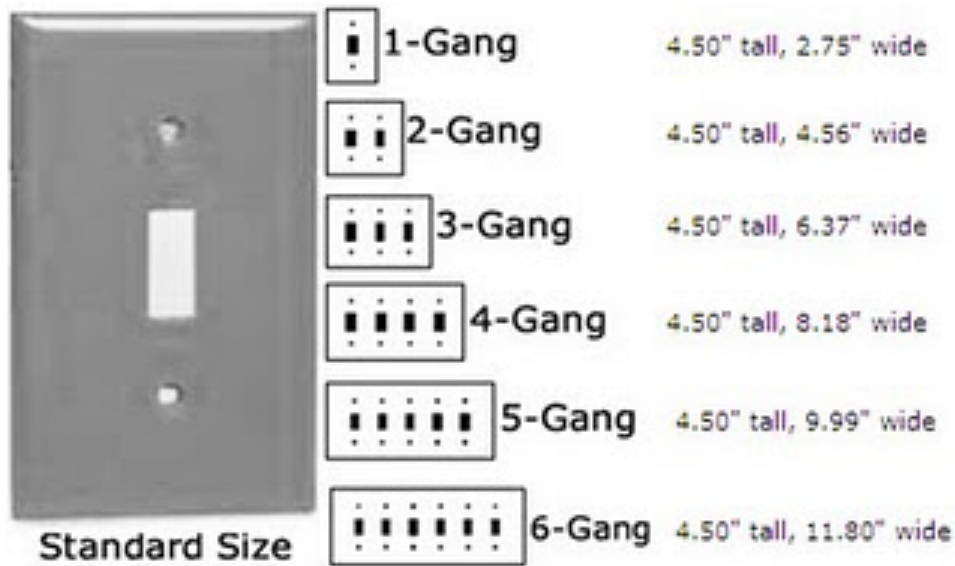

Fittings - Parts of a wiring system designed to interconnect conduit, conductors, or boxes.

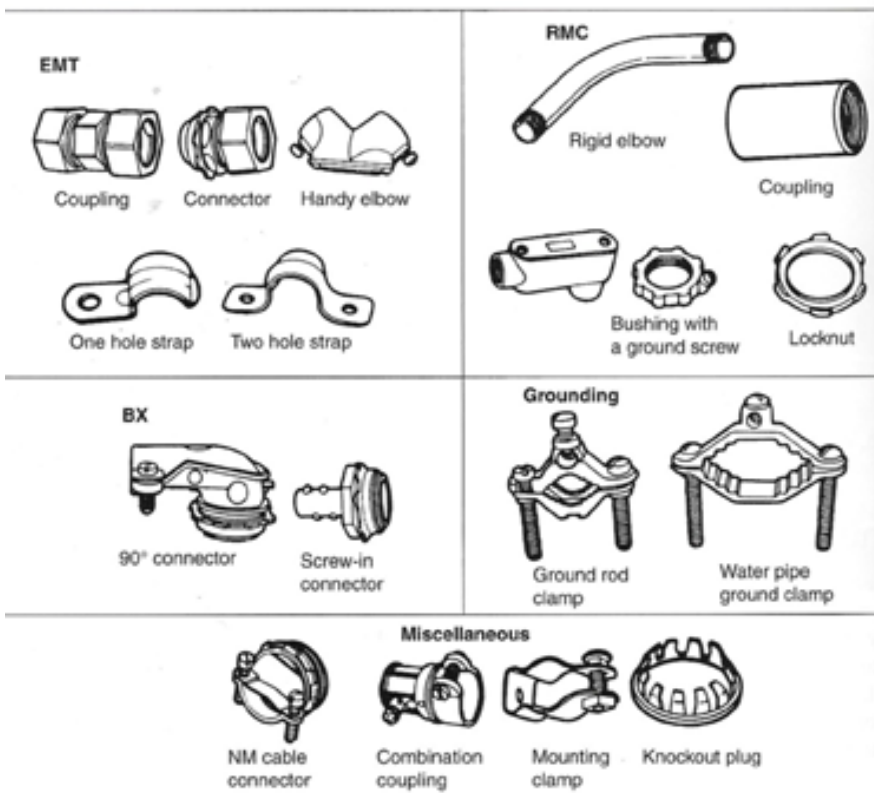



_____ - Fittings that secure conduit or the outer covering of armored cable to an electrical box

_____ - fittings that secure nonmetallic cable to an electrical box.

_____ - a spring device that is hooked over the edge of a metallic box and holds a grounding wire so that the wire makes electrical contact with the box

_____ - Boxes without a bottom that are used to provide additional space or bring an existing box flush to a wall or ceiling surface.



_____ - A flat metallic or nonmetallic plate that is placed over a mounted switch or outlet, and is large enough to cover the wiring and exposed terminals that are in the box also called a faceplate.

